

INDUSTRIAL INKJET PRINTING FOR DECORATIVE SURFACES

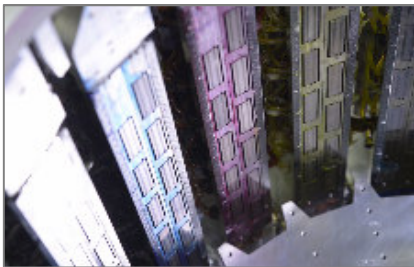

RICOH
Powered by
RICOH

EXAMPLE: OFF-LINE PRINTING LINE

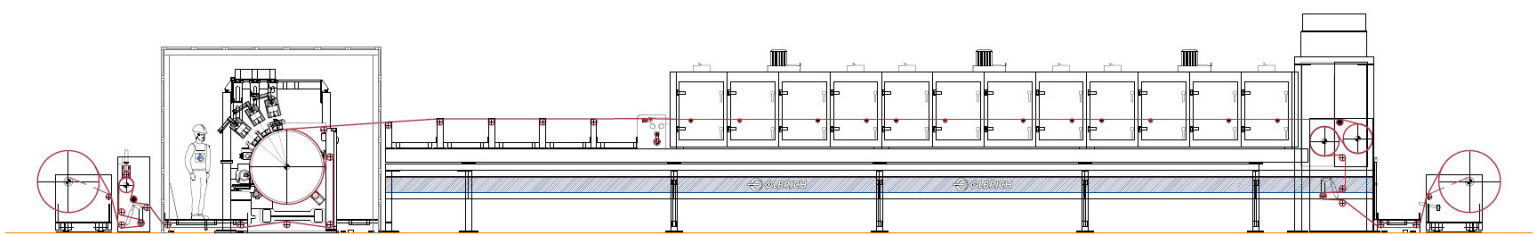

EXAMPLE: IN-LINE PRINTING LINE

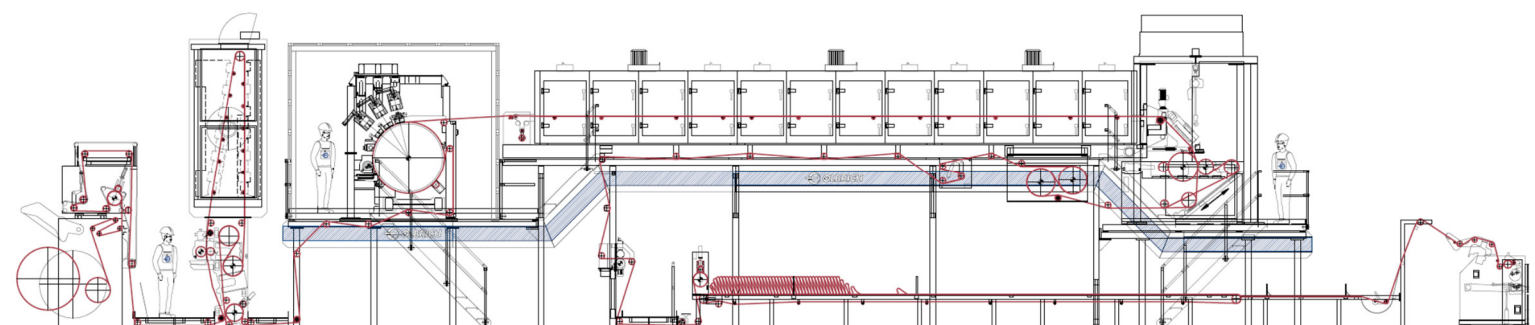

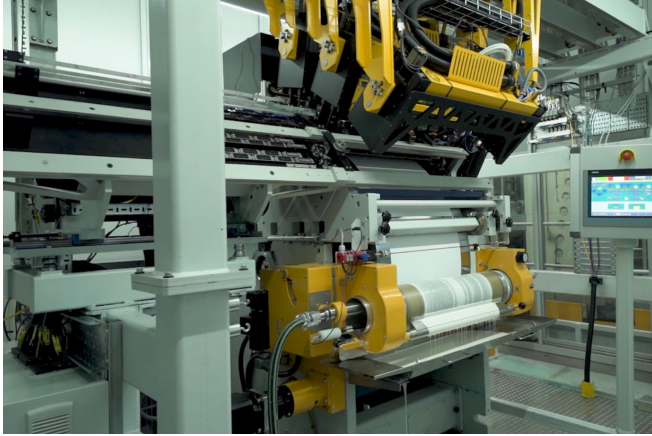

The unique industrial inkjet printing technology is most suitable for decorative products such as wallcoverings, decorative films, floor coverings and similar PVC-based products.

There is no need for specific ink reception layers, primer coatings or any pre-treatment of the printing substrate. The special ink is absorbed by and embedded in the wet plastisol.

The single-pass technology is perfectly suitable for integration into existing industrial printing lines. It is furthermore available as a dedicated stand-alone printing line, off-line or near-line.

INDUSTRIAL INKJET TECHNOLOGY FOR SINGLE PASS PRINTING

Technical Data:

Operating printing speed:	max 70 m/min
Operating mode:	in-line, single-pass
Printing widths:	550mm, 1000mm, 1200mm, 1400mm
Number of print bars:	4 (CMYK)
Heads:	Ricoh MH5420
Ink type:	oil based ink



REFERENCE: CUSTOMER PRODUCTS

